

**Features**

- Wide Band
- High Sensitivity
- Low VSWR

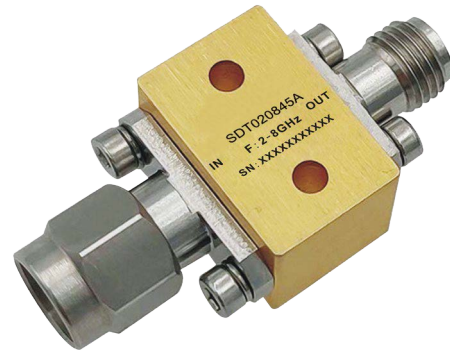

Parameters	Min.	Typ.	Max.	Units
Frequency Range	2 - 8			GHz
VSWR			1.2	: 1
Tss		-30		dBm
Sensitivity		0.5		Mv / uw
Input Power			23	dBm
Output Polarity	Positive (+)			
Weight	0.4 Max.			ounces
Input / Output Connectors	SMA-Male / SMA-Female			
Material	Aluminum			
Finish	Gold Plated			

**Environmental Specifications**

Operational Temperature(°C)	-40°C~+85°C(Case Temperature)
Storage Temperature (°C)	-50°C~+105°C
Altitude	30,000 ft. (Epoxy Sealed Controlled environment)
	60,000 ft. 1.0psi min (Hermetically Sealed Un-controlled environment) ( Optional )
Vibration	25g RMS (15 degrees 2KHz) endurance, 1 hour per axis
Humidity	100% RH at 35°C, 95%RH at 40°C
Shock	20G for 11msec half sine wave,3 axis both directions

**Outline Drawing:**

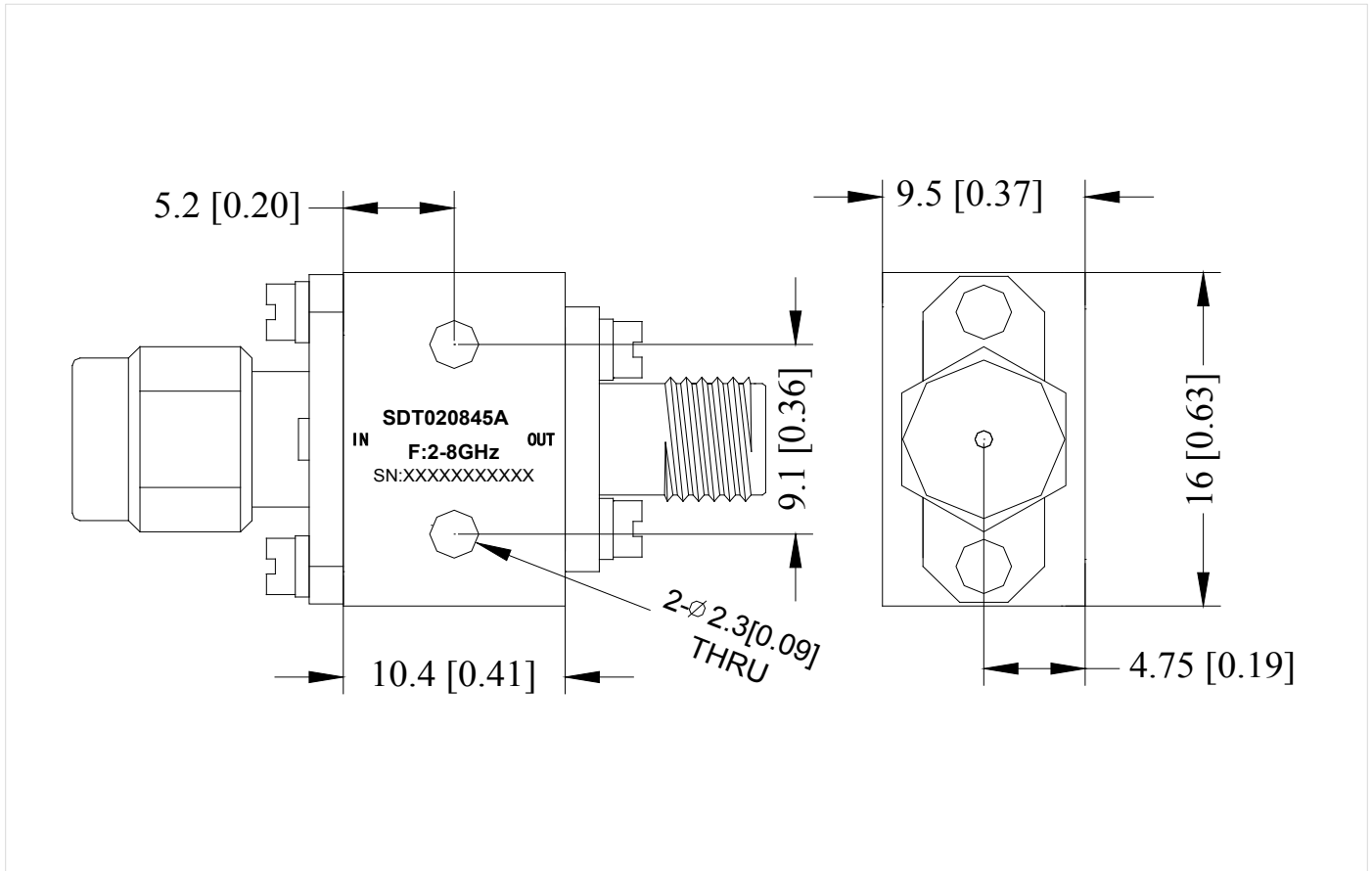
 All Dimensions in mm (inches) Tolerances  $\pm 0.15$  (0.006)

Wide Band Power Detector 2 - 8GHz

VSWR @+25°C

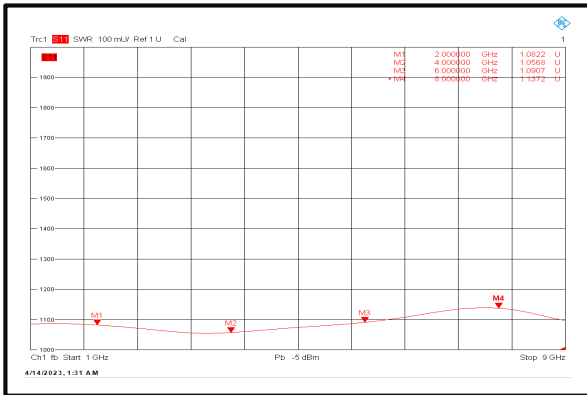

VSWR @-40°C

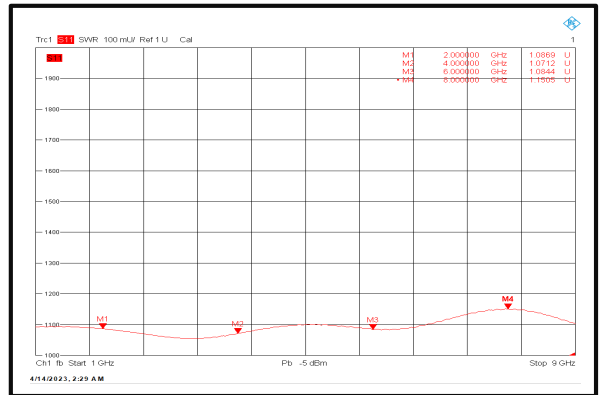

VSWR @+85°C

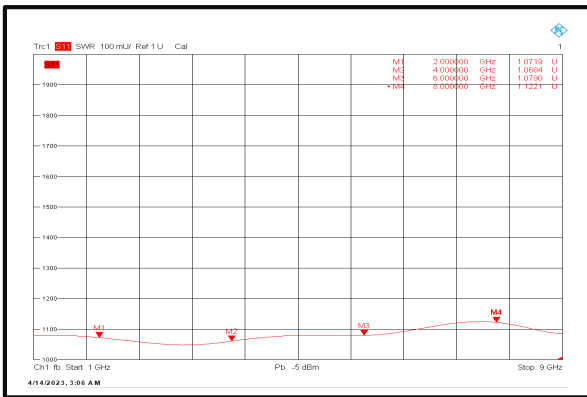

Output DC Voltage vs. Input Power

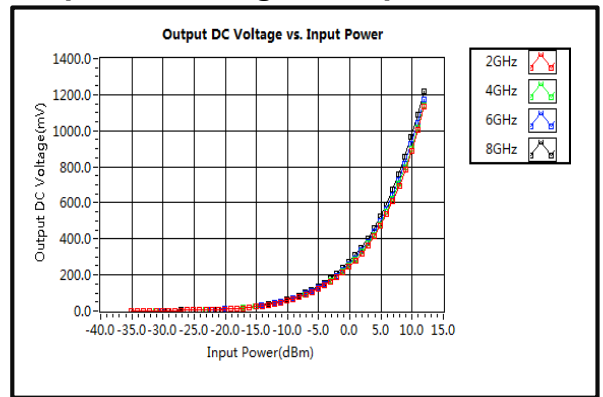

Rise Time

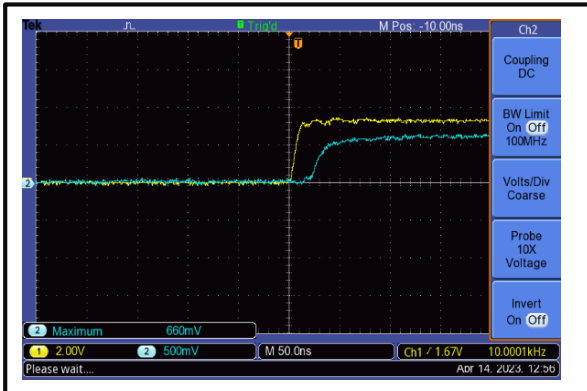

Fall Time

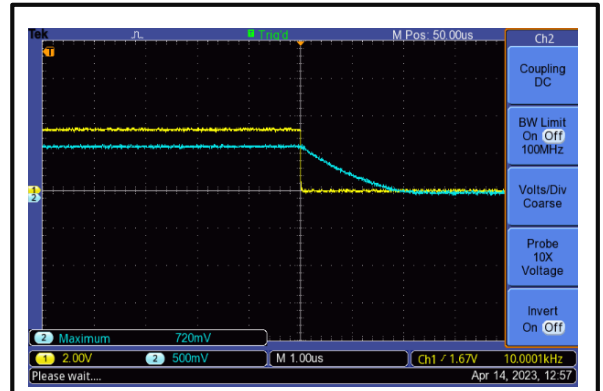

Saluki and its affiliates reserve the right to make changes to the product(s) or information contained herein without notice. Visit [www.salukitec.com](http://www.salukitec.com) for additional data sheets and product information.